



City of Bonner Springs

KANSAS

Monday, March 17, 2025
200 East Third Street, Bonner Springs, KS 66012

RECREATION AND OPEN SPACES ADVISORY COMMITTEE - 5:30 PM

[IGNORE_NUMBERING]

OLD BUSINESS

[IGNORE_NUMBERING]

1. Lions Park Basketball Court

Action

Recommendation Table for next meeting.

Documents:

2. Cedar Ridge Disc Golf - Sponsorships

Action [AGENDA_ITEM_CUSTOM_TEXT_1]

Recommendation Table until the next meeting.

Documents:

NEW BUSINESS

[IGNORE_NUMBERING]

1. Memorial Day Service

Action Discussion

Recommendation [AGENDA_ITEM_CUSTOM_TEXT_2]

Documents:

2. Tree Planting - Owned Gravesite

Action Discussion

Recommendation [AGENDA_ITEM_CUSTOM_TEXT_2]

Documents:

3. Community Center Exterior Painting

Action Presentation & Discussion

Recommendation [AGENDA_ITEM_CUSTOM_TEXT_2]

Documents:

1. us204PaintingCC

REPORTS

[IGNORE_NUMBERING]

1. Cementery Update

Action [AGENDA_ITEM_CUSTOM_TEXT_1]

Recommendation [AGENDA_ITEM_CUSTOM_TEXT_2]

Documents:

2. Recreation Update

CITIZEN CONCERNS

[IGNORE_NUMBERING]

Memorandum

Date:	March 17, 2025
To:	PARK BOARD
From:	
Subject:	Lions Park Basketball Court
Recommendation: Table for next meeting.	
Action:	
Background:	
Discussion:	
Financial Impact:	

Memorandum

Date:	March 17, 2025
To:	PARK BOARD
From:	
Subject:	Cedar Ridge Disc Golf - Sponsorships

Recommendation: Table until the next meeting.

Action:

Background:

Discussion:

Financial Impact:

Memorandum

Date:	March 17, 2025
To:	PARK BOARD
From:	Christina Brake
Subject:	Memorial Day Service

Recommendation:

Action: Discussion

Background: Each year, on Memorial Day, a ceremony takes place at the cemetery to commemorate area veterans.

Discussion:

Financial Impact:

Memorandum

Date:	March 17, 2025
To:	PARK BOARD
From:	Christina Brake
Subject:	Tree Planting - Owned Gravesite
Recommendation:	
Action: Discussion	
Background:	
Discussion:	
Financial Impact:	

Memorandum

Date:	March 17, 2025
To:	PARK BOARD
From:	Nathan Brungardt
Subject:	Community Center Exterior Painting

Recommendation:

Action: Presentation & Discussion

Background:

Discussion: During a community event, City staff learned that Bonner Springs High School (BSHS) students were studying mural painting. This led to the idea of partnering with USD 204 to provide art students with a hands-on learning experience in creating murals.

As part of scheduled maintenance, the Bonner Springs Community Center will be repainted. City staff recognized this as an opportunity to allow the community to create temporary murals on the building before repainting.

Financial Impact:



**BONNER SPRINGS
EDWARDSVILLE**

BRUSH THE SPRINGS

**PAINTING TODAY;
INSPIRING TOMORROW**

A partnership between the City of Bonner Springs and
USD 204



City of Bonner Springs
PARKS AND RECREATION

OVERVIEW OF THE PROJECT

- Learning Experience for USD 204 Students
- All Murals are Temporary
- Art is in the Eye of the Beholder



GENERAL RULES

1. Eligibility

a. BSHS Student

2. Design Submission

a. USD 204 Approval

3. Theme Guidelines

a. community pride, positivity, and creativity

4. Final Approval

a. USD 204 and the City reserve the right to request changes or deny design

GENERAL RULES

1. Supervision Required

- a. By USD 204 Approved Staff Member

2. Scheduled Work Times

- a. For supervision; prevent vandalism

3. Materials Provided

- a. By USD 204 or Students
- b. Materials **MUST** be approved by the City
 - i. Cannot add texture to the building.

4. Ladders & Scaffolding - **NOT ALLOWED**

CONSIDERATIONS FOR MURAL LOCATIONS

1. Potential for Damage

- a. Accidental painting of window frames or unpainted brick
- b. Paint spills on concrete
- c. Damage to existing landscaping

2. Accessibility

- a. Consideration of the sloped ground between the Community Center and Maple Street

COMMUNITY CENTER PONY WALL

- USD 204 may divide space as needed.
- Drainage holes must remain uncovered.
- Murals must maintain a 3-inch clearance from unpainted brick.
- Groundwork (e.g., moving dirt) is not allowed.

Inside
the Red?
Paintable
Area



ELM STREET – COMMUNITY CENTER (THREE AREAS BETWEEN WINDOWS)

- One mural per section is recommended.
- Murals must maintain a 3-inch clearance from window frames and unpainted brick.
- Murals should not exceed window height.



***Water Spicket**

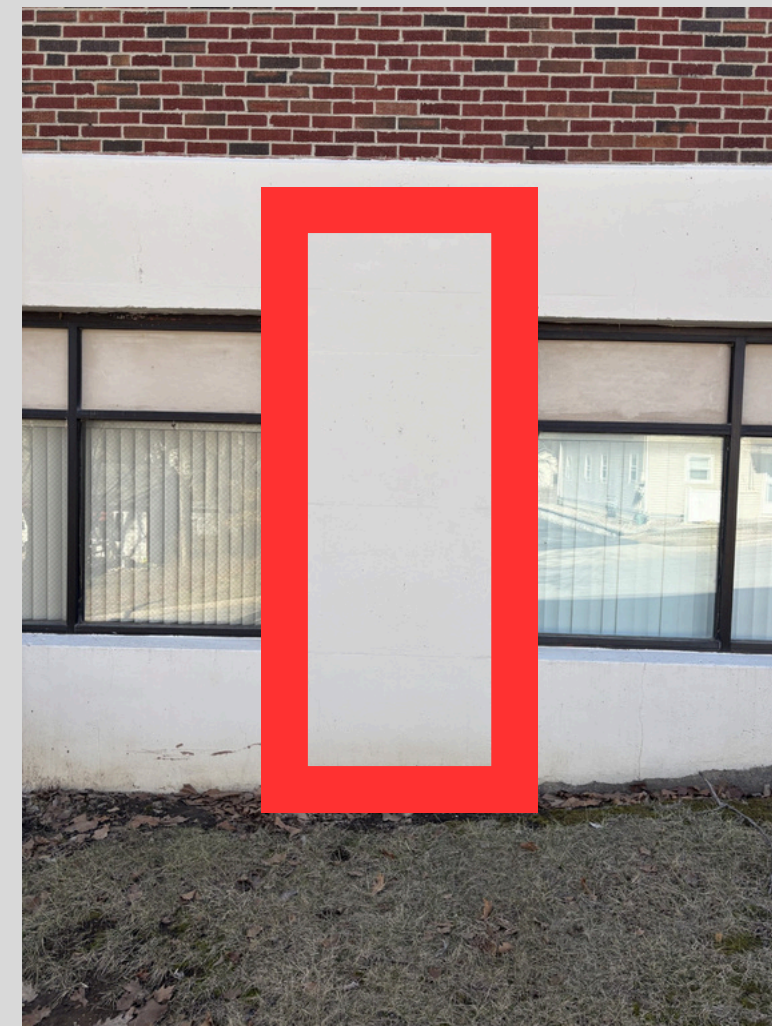
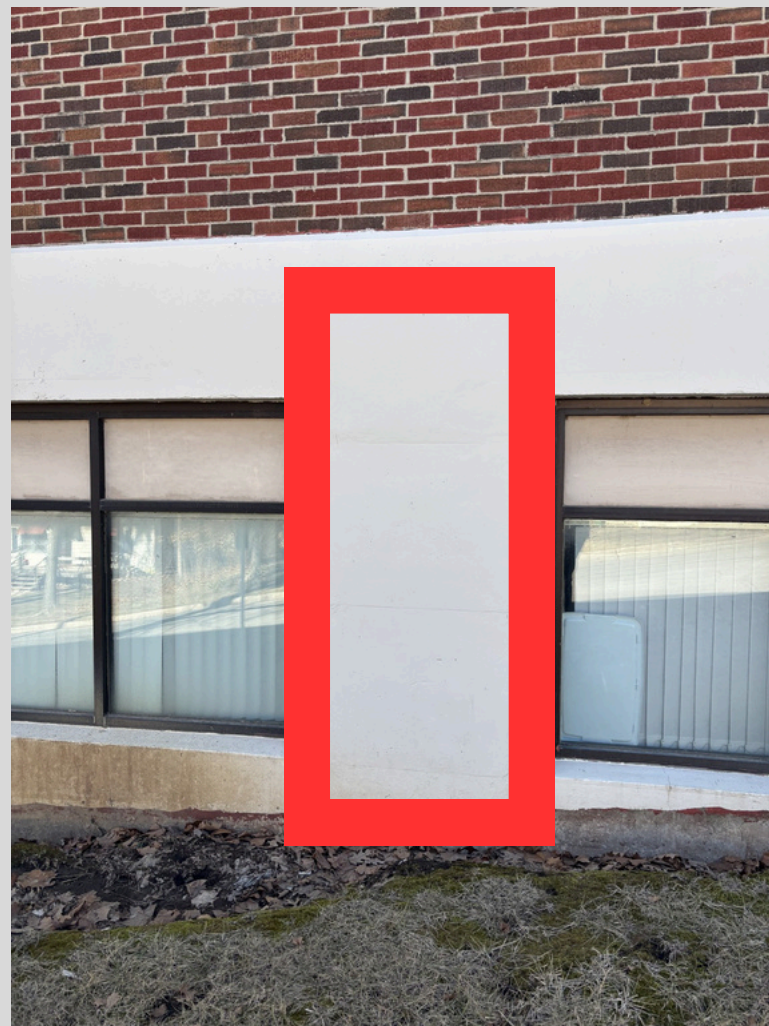

ELM STREET – COMMUNITY CENTER (UNDER THE STAIRWELL)

- Three murals are recommended.
- Murals must maintain a 3-inch clearance from window frames, door frames, and light fixtures.
- Painting of the stairwell and railing is NOT allowed (support structure painting is negotiable).



*Light Fixture

ACCESS ROAD – COMMUNITY CENTER (BETWEEN SENIOR CENTER OFFICE WINDOW & SIDE ACCESS DOOR)

- Two murals are recommended.
- Murals must maintain a 3-inch clearance from window frames, gutters, electrical boxes, and unpainted brick.
- The covered entry and its supports are **NOT** included in the painting area.
- Piping and wire housing **CANNOT** be painted.



*Light Fixture

ACCESS ROAD– SENIOR CENTER POOL ROOM (REQUIRES COUNCIL APPROVAL)

- Most visible option
- City Council approval is required due to its proximity to concrete and landscaping risks.
- Murals must maintain a 3-inch clearance from window frames, gutters, light fixtures, and unpainted brick.

ROSA Opinion - send to council or remove!?!





RECOGNITION AND COMMUNITY ENGAGEMENT

- Artist Credit
- OPTINAL Community Showcase
- Photo and Media Release



**QUESTIONS
&
COMMENTS**